

MINIATURE HERMETIC ELECTRONIC CONNECTORS-DS SERIES

MIL-DTL-5015 TYPE, COMMERCIAL EQUAL HERMETIC GLASS-TO-METAL SEALED (VACUUM / PRESSURE FEED THRU)

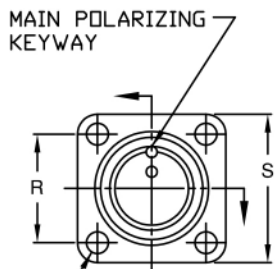

.120 \pm .005 - SHELL SIZES 8 THRU 22
.147 \pm .005 - SHELL SIZE 28

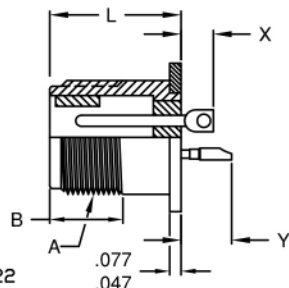

DS02H - 111 SQUARE FLANGE MOUNT CONNECTORS (MS3142 CLASS H TYPE)

| PART NO. | S \pm .031 | R T.P. C-C | L MAX. | B MIN. THD. | A THREAD \dagger CLASS-2A |
|-------------------|-----------------|------------------|-----------|-------------------|-----------------------------------|
| DS02H-10SL-* -111 | 1.000 | .719 | .730 | .375 | .625-24 UNEF |
| DS02H-12S-* -111 | 1.094 | .812 | .730 | .375 | .750-20 UNEF |
| DS02H-14S-* -111 | 1.188 | .906 | .730 | .375 | .875-20 UNEF |
| DS02H-16S-* -111 | 1.281 | .969 | .730 | .375 | 1.000-20 UNEF |
| DS02H-18-* -111 | 1.375 | 1.062 | .915 | .625 | 1.125-18 UNEF |
| DS02H-20-* -111 | 1.500 | 1.156 | .915 | .625 | 1.250-18 UNEF |
| DS02H-22-* -111 | 1.625 | 1.250 | .915 | .625 | 1.375-18 UNEF |
| DS02H-28-* -111 | 2.000 | 1.562 | .915 | .625 | 1.750-18 UNS |
| CONTACT SIZE 16 | | X MAX. .219 | | Y MAX. .375 | |

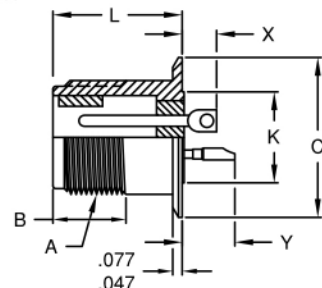
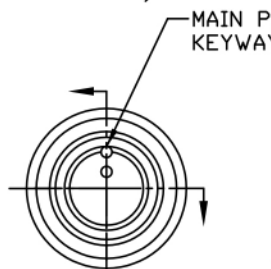

DS02H - 251 ROUND FLANGE MOUNT CONNECTORS (MIS3143 CLASS H TYPE)

| PART NO. | K \pm .010 | C \pm .010 | L MAX. | B MIN. THD. | A THREAD \dagger CLASS-2A |
|-------------------|-----------------|-----------------|-----------|-------------------|-----------------------------------|
| DS02H-10SL-* -251 | .490 | .875 | .730 | .375 | .625-24 UNEF |
| DS02H-12S-* -251 | .646 | 1.000 | .730 | .375 | .750-20 UNEF |
| DS02H-14S-* -251 | .709 | 1.125 | .730 | .375 | .875-20 UNEF |
| DS02H-16S-* -251 | .834 | 1.250 | .730 | .375 | 1.000-20 UNEF |
| DS02H-18-* -251 | .959 | 1.375 | .915 | .625 | 1.125-18 UNEF |
| DS02H-20-* -251 | 1.146 | 1.500 | .915 | .625 | 1.250-18 UNEF |
| DS02H-22-* -251 | 1.240 | 1.625 | .915 | .625 | 1.375-18 UNEF |
| DS02H-28-* -251 | 1.615 | 2.000 | .915 | .625 | 1.750-18 UNS |
| CONTACT SIZE 16 | | X MAX. .219 | | Y MAX. .375 | |

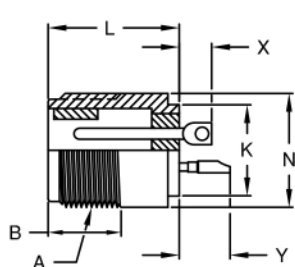
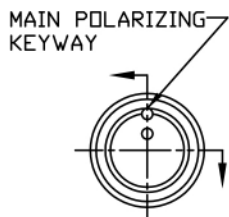

DS02H - 001 FLANGELESS MOUNT CONNECTORS

| PART NO. | K \pm .010 | N +.000 -.062 | L MAX. | B MIN. THD. | A THREAD \dagger CLASS-2A |
|-------------------|-----------------|---------------------|-----------|-------------------|-----------------------------------|
| DS02H-10SL-* -001 | .490 | .656 | .730 | .375 | .625-24 UNEF |
| DS02H-12S-* -001 | .646 | .782 | .730 | .375 | .750-20 UNEF |
| DS02H-14S-* -001 | .709 | .906 | .730 | .375 | .875-20 UNEF |
| DS02H-16S-* -001 | .834 | 1.032 | .730 | .375 | 1.000-20 UNEF |
| DS02H-18-* -001 | .959 | 1.156 | .915 | .625 | 1.125-18 UNEF |
| DS02H-20-* -001 | 1.146 | 1.282 | .915 | .625 | 1.250-18 UNEF |
| DS02H-22-* -001 | 1.240 | 1.406 | .915 | .625 | 1.375-18 UNEF |
| DS02H-28-* -001 | 1.615 | 1.782 | .915 | .625 | 1.750-18 UNS |
| CONTACT SIZE 16 | | X MAX. .219 | | Y MAX. .375 | |

* ADD DESIRED INSERT ARRANGEMENT.

▼ INSERT ARRANGEMENT IS SHOWN IN NORMAL POSITION.

† AFTER PLATING, SUBJECT TO ACCEPTANCE USING A BASIC CLASS 3A GO GAGE.

OTHER SHELL SIZES, PIN PATTERNS AND INSERT POSITIONS MAY BE AVAILABLE - CONSULT FACTORY.

MATERIAL: STANDARD IS CRS SHELL, 52 NICKEL ALLOY PINS AND NO INTERFACIAL SEAL.

STANDARD PIN IS EYELET TYPE. OTHER PIN TYPES ALSO AVAILABLE

(SOLDER CUP, STRAIGHT, THERMOCOUPLE) - CONSULT FACTORY.

STANDARD FINISH IS TIN PLATED SHELL AND PINS.

OTHER FINISHES ALSO AVAILABLE (GOLD, NICKEL, OLIVE DRAB, etc.) - CONSULT FACTORY.

SPECIALS CAN BE SUPPLIED TO MEET CUSTOMER SPECIFICATIONS - CONSULT FACTORY.

OUR CONNECTORS MATE WITH ANY PLUG WITH SOCKET CONTACTS WHICH MEET THE DIMENSIONAL REQUIREMENTS OF MIL-DTL-5015 AND MS3106.

GENERAL SPECIFICATIONS

AIR LEAKAGE: 1x10⁻⁶ CM³/SEC AT 15psi

INSULATION RESISTANCE: 5,000 megohms AT 500VDC

OPERATING TEMPERATURE: -67°F TO +347°F (-55°C TO +175°C)

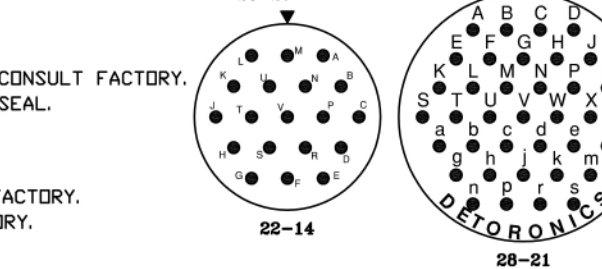
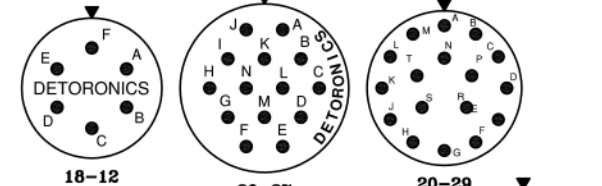
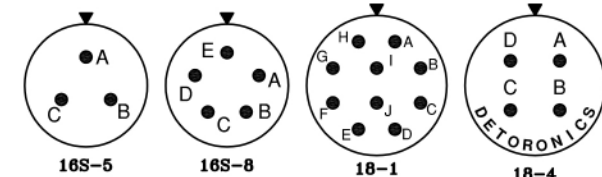
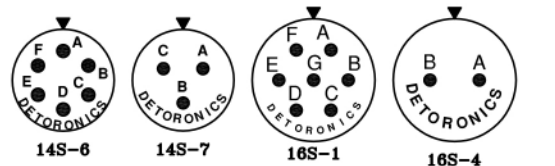
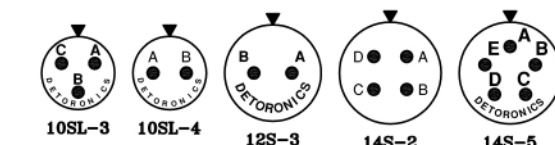

ENGAGING FACE PIN INSERTS

Detoronics Corporation

13071 ROSECRANS AVE, SANTA FE SPRINGS, CA 90670

TELE: (626) 579-7130 FAX: (626) 579-1936

www.detoronics.com